

10

FULL HGT. PARTITION CONNECTION

7

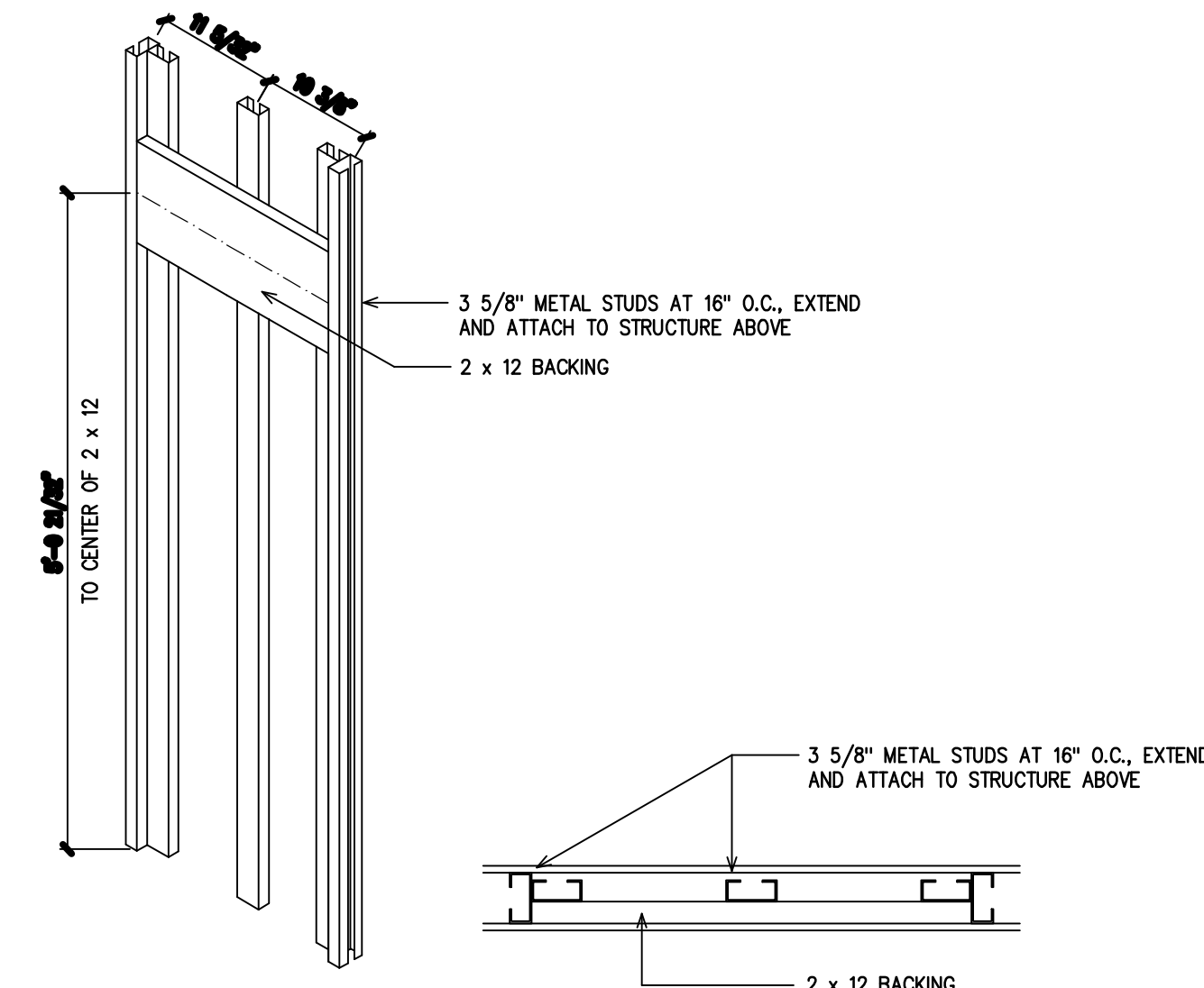

NOTES:  
1. EQUIPMENT BACKING TO SUPPORT 500 LBS. OF TORQUE WEIGHT.  
2. FACE OF BACKING FLUSH w/ STUDS. SEE FLOOR PLAN FOR LOCATIONS.

4

PAN BACKING DETAIL

4

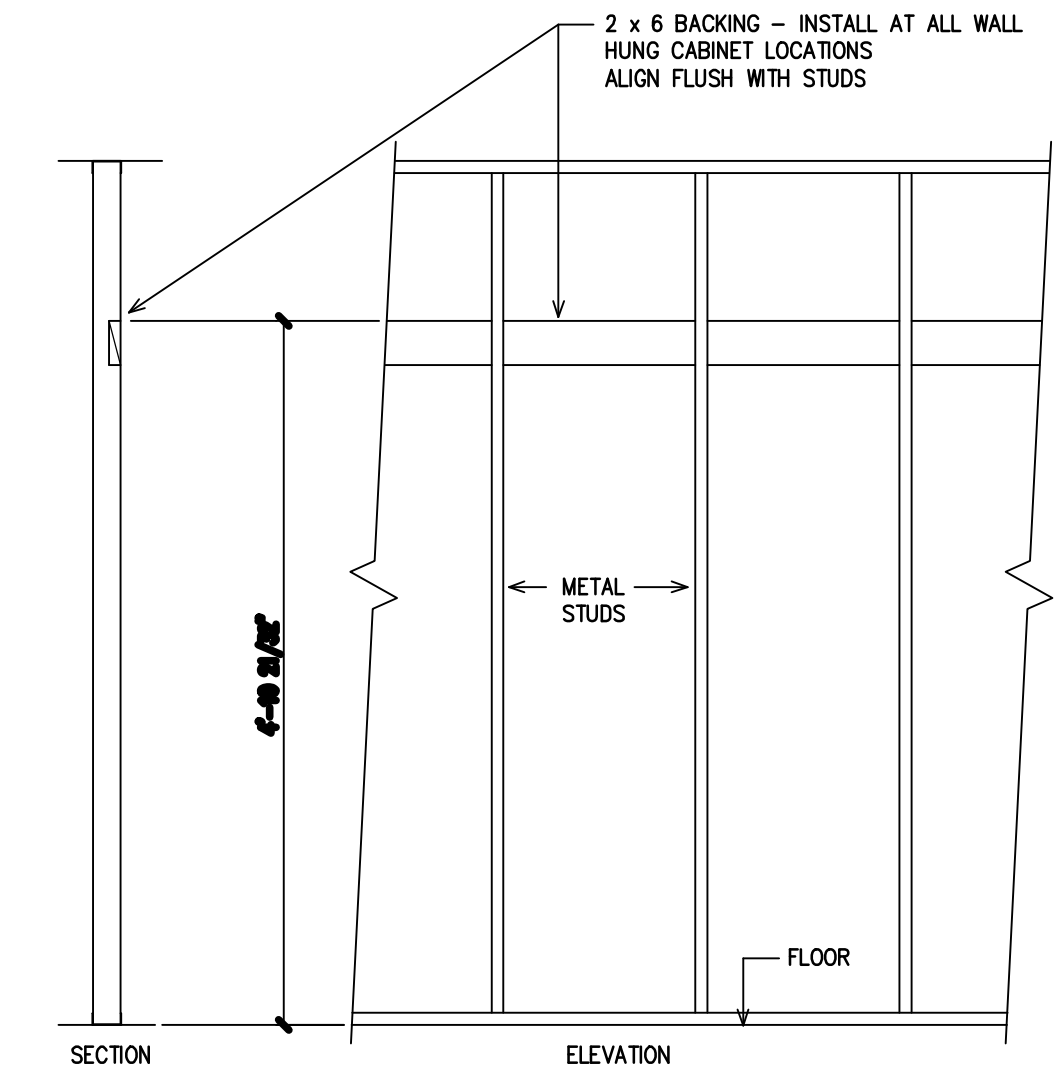

COORDINATE WITH FLOOR PLAN (A-2.1) AND CABINET ELEVATIONS (A-6.3)  
BACKING IS REQUIRED AT EACH WALL HUNG CABINET LOCATION.

WALL HUNG CABINET BACKING

NO.	REVISION	BY	DATE

**HANDLEY ENGINEERING**  
130 EL CAMINO REAL TUSTIN CA 92780  
SUITE 200 (714) 669-1141

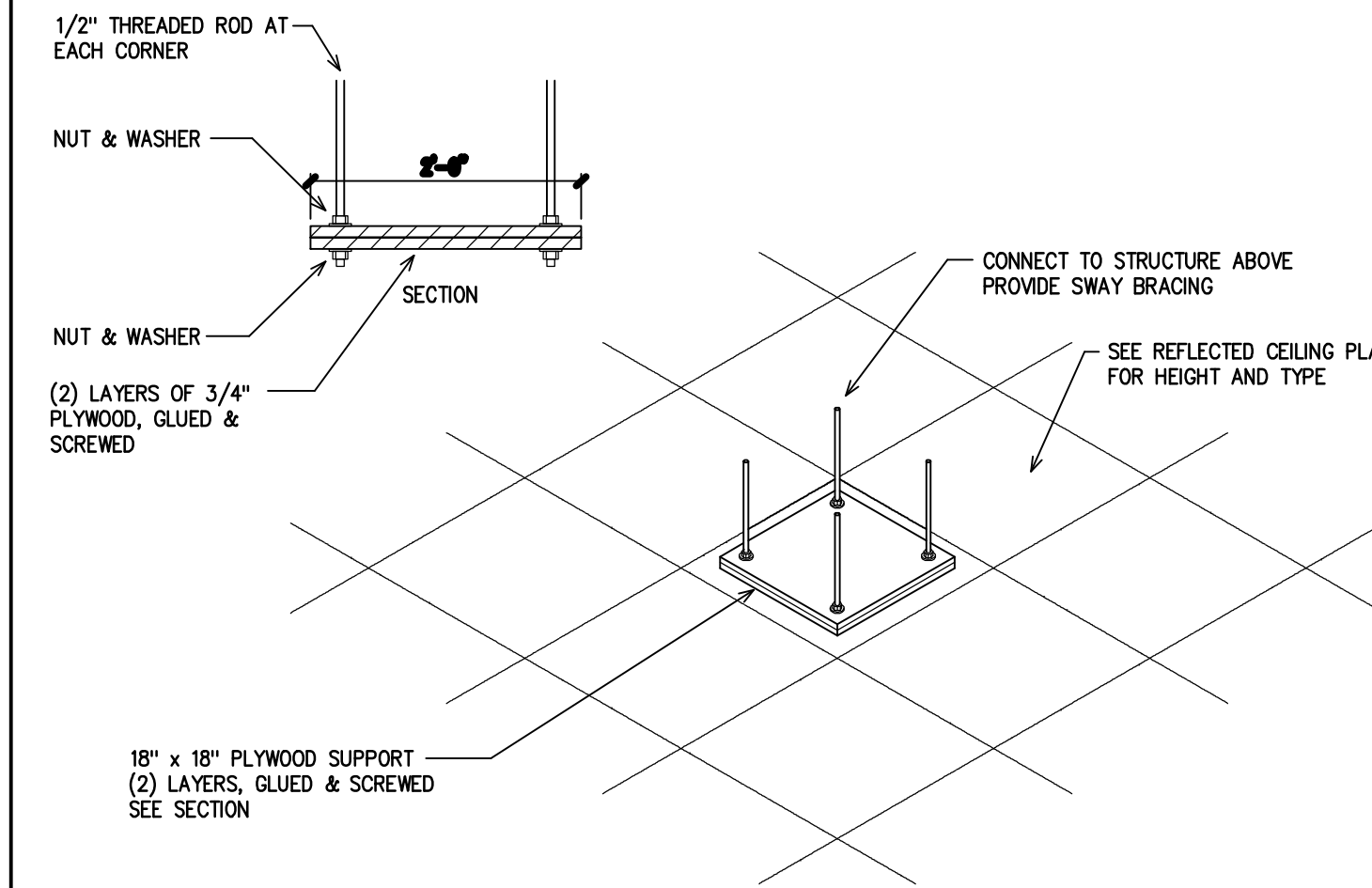
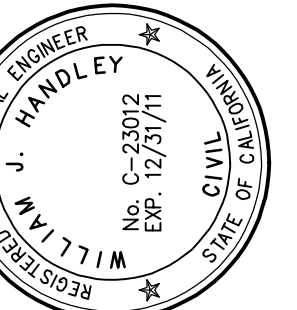

NOTES:  
1. EQUIPMENT BACKING TO SUPPORT 300 LBS. OF TORQUE WEIGHT.  
2. BOTTOM OF PLYWOOD TO BE FLUSH WITH BACK OF GRID SYSTEM.

8

CEILING MOUNTED MONITOR BACKING

5

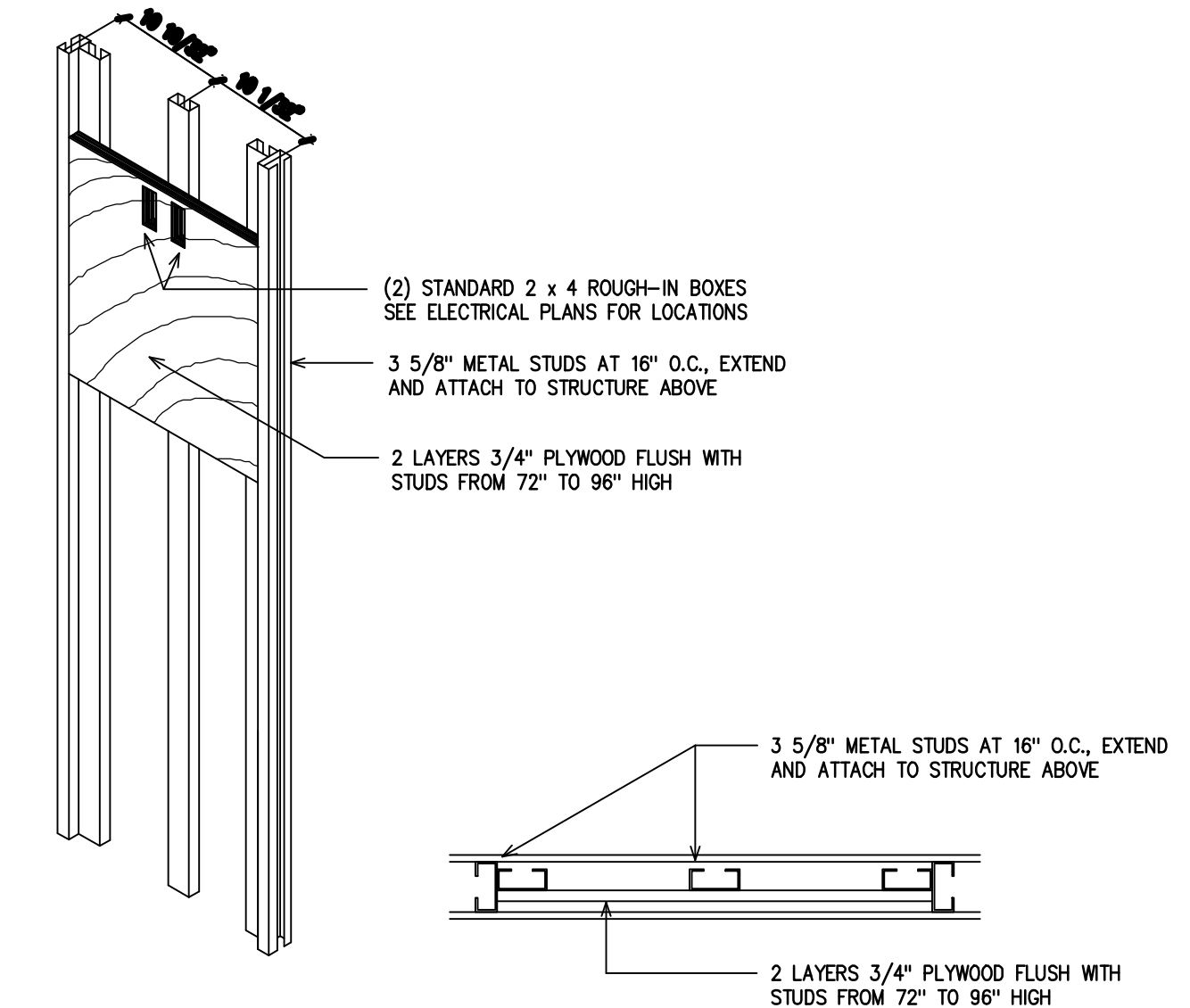

NOTES:  
1. EQUIPMENT BACKING TO SUPPORT 250 LBS. OF TORQUE WEIGHT.  
2. FACE OF BACKING FLUSH w/ STUDS. SEE FLOOR PLAN FOR LOCATIONS.

WALL MOUNTED MONITOR BACKING

2

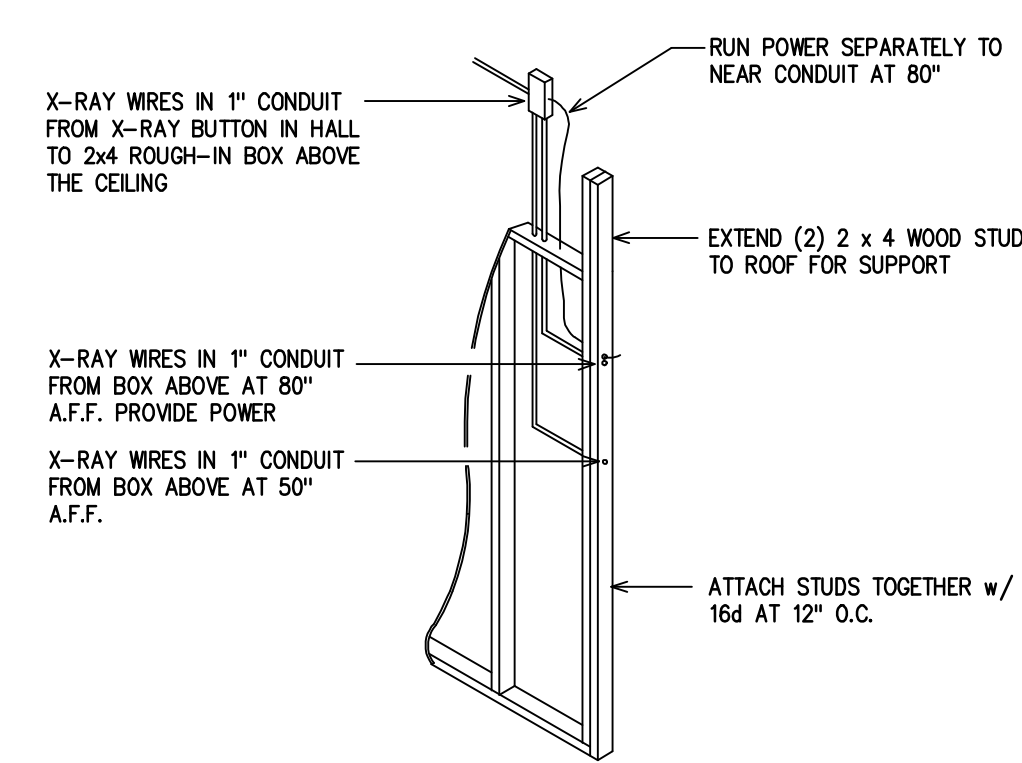

NOTES:  
1. 43 1/2 INCH VERTICAL DIMENSION REFERENCES FRAMING REQUIREMENT IF THE X-RAY MODULE WILL BE PLACED ABOVE A DENTAL CABINET THAT IS INSTALLED WITH THE COUNTERTOP AT THE STANDARD 32 INCH HEIGHT. ALLOW THE X-RAY MODULE TO BE OPENED WITHOUT INTERFERING WITH THE SINK OPERATION.  
2. PROVIDE WOOD BACKING WHERE BOLTED MOUNTING CONNECTION IS LOCATED FOR X-RAY.

9

X-RAY END WALL MOUNT

6

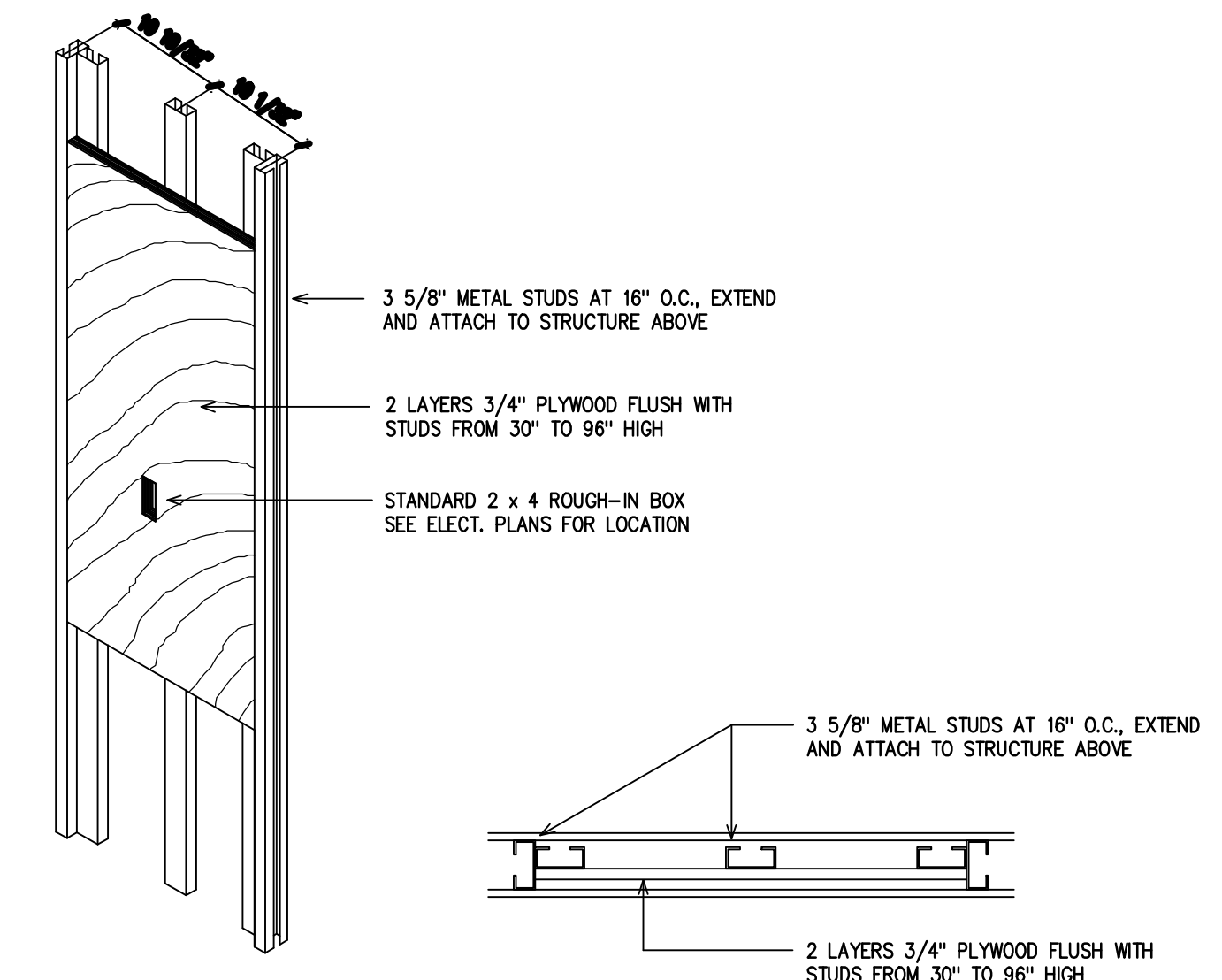

NOTES:  
1. EQUIPMENT BACKING TO SUPPORT 500 LBS. OF TORQUE WEIGHT.  
2. FACE OF BACKING FLUSH w/ STUDS. SEE FLOOR PLAN FOR LOCATIONS.

EQUIPMENT BACKING DETAIL

3

11

12

NEW PROFESSIONAL OFFICE FOR:  
**JAMES HOCH, D.D.S.**  
32246 CLINTON KEITH ROAD, WILDOMAR, CA 92595

DATE:	11/28/11
JOB NO:	11-23
DRAWN:	WJH
CHECKED:	WJH
SCALE:	NONE
SHEET	

A-7.3

OF SHEETS